



Design That **Suit Your**
Style



MAKE
LUXURIOUS
BATHROOM

W.E.F. October 2023

NOW WITH **7** YEAR WARRANTY

**Har Ghar Ki Pahechan
Accsan Bath Ke Sath.....**

ABOUT US

Product Range

Bathroom Fittings
Faucets
Showers
Health Faucets
Bath Accessories

Company Profile

We are familiar with the industry requirements and application demands pertaining to our products. Further, the experience of 5 years justifies our credibility as an eminent Manufacturer and Supplier of Bathroom Fittings, Bathroom Fittings, Faucets, Showers, Health Faucets, Bath Accessories Further more, we have a capacious warehouse and wide network of transporters for safe storage and timely delivery of the same.
Business Type , Manufacturer , Trader , Wholesaler , Supplier



7
Year
Warranty



Finest Quality
Control



Suitable For
Hot & Cold Water



Low
Maintenance



Perfect
Flow

Primary Competitive Advantages

Experienced professionals
Timely delivery of consignments
Various payment options
Capacious warehouse

INDEX

CRUZ Collection	4	FLORA Collection
CERAON Collection	5	ALEXA Collection
ROYAL Collection	6	KUBIX Collection
CRETA Collection	7	NEXA Collection
AUSTIN Collection	8	STICK Collection
FLORET Collection	9	FIGO Collection
SIGNET Collection	10	PRIZA Collection
ELEGENCE Collection	11	DELENO Collection
	12	
	13	
	14	
	15	
	16	
	17	
	18	
	19	



CAT NO.: A-1201
BIB COCK
MRP: 990/-



CAT NO.: A-1202
PILLAR COCK
MRP: 1200/-



CAT NO.: A-1203
ANGLE COCK
MRP: 830/-



CAT NO.: A-1204
BIB COCK LONG BODY
MRP: 1290/-



CAT NO.: A-1205
2 WAY ANGLE COCK
MRP: 1840/-



CAT NO.: A-1206
CONCEALED STOP COCK
15MM THREAD MRP: 1250/-
20MM THREAD MRP: 1360/-



CAT NO.: A-1207
SINK COCK (W/M)
MRP: 1650/-



CAT NO.: A-1208
SINK COCK EXTENDED SPOUT (W/M)
MRP: 2050/-



CAT NO.: A-1209
SWAN NECK (T/M)
MRP: 1760/-



CAT NO.: A-1210
SWAN NECK EXTENDED SPOUT(T/M)
MRP: 2200/-



CAT NO.: A-1211
SINK MIXER
MRP: 4015/-



CAT NO.: A-1212
SINK MIXER EXTENDED SPOUT
MRP: 4820/-



CAT NO.: A-1213
WALL MIXER WITH BEND
MRP: 5620/-



CAT NO.: A-1214
PILLAR COCK TALL BODY
MRP: 3220/-



CAT NO.: A-1215
FLUSH COCK
MRP: 1850/-



CAT NO.: A-1216
HIGH FLOW SINGLE LEVER DIVERTOR
MRP: 2860/-



CAT NO.: A-1217
CONCEALED WALL MIXER
MRP: 6130/-



CAT NO.: A-1218
HIGH FLOW SINGLE LEVER
DIVERTOR COMPLETE SET
MRP: 7050/-



CAT NO.: A-1101
BIB COCK
MRP: 960/-



CAT NO.: A-1102
PILLAR COCK
MRP: 1380/-



CAT NO.: A-1103
ANGLE COCK
MRP: 810/-



CAT NO.: A-1104
BIB COCK LONG BODY
MRP: 1260/-



CAT NO.: A-1105
2 WAY BIB COCK
MRP: 1810/-



CAT NO.: A-1106
CONCEALED STOP COCK
15MM THREAD MRP: 1250/-
20MM THREAD MRP: 1350/-



CAT NO.: A-1107
SINK COCK (W/M)
MRP: 1640/-



CAT NO.: A-1108
SWAN NECK (T/M)
MRP: 1750/-



CAT NO.: A-1109
SINK MIXER
MRP: 4010/-



CAT NO.: A-1110
WALL MIXER WITH BEND
MRP: 5500/-



CAT NO.: A-1111
FLUSH COCK 25MM
MRP: 1830/-



CAT NO.: A-1112
3 IN 1 WALL MIXER
MRP: 5850/-





CAT NO.: A-1301
BIB COCK
MRP: 875/-



CAT NO.: A-1302
PILLAR COCK
MRP: 1275/-



CAT NO.: A-1303
ANGLE COCK
MRP: 810/-



CAT NO.: A-1304
BIB COCK LONG BODY
MRP: 1175/-



CAT NO.: A-1305
2 WAY BIB COCK
MRP: 1715/-



CAT NO.: A-1306
CONCEALED STOP COCK
15MM THREAD MRP: 1250/-
20MM THREAD MRP: 1350/-



CAT NO.: A-1307
SINK COCK (W/M)
MRP: 1700/-



CAT NO.: A-1308
SWAN NECK (T/M)
MRP: 1950/-



CAT NO.: A-1309
CENTER HOLE BASIN MIXER
MRP: 4150/-



CAT NO.: A-1310
SINK MIXER
MRP: 4670/-



CAT NO.: A-1311
WALL MIXER WITH BEND
MRP: 6100/-



CAT NO.: A-1312
PILLAR COCK TALL BODY
MRP: 3080/-



CAT NO.: A-1313
FLUSH COCK 25MM
MRP: 1700/-



CAT NO.: A-1314
3 IN 1 WALL MIXER
MRP: 6375/-



CAT NO.: A-1315
WALL MIXER WITH CRUTCH
MRP: 6100/-



CAT NO.: A-1316
HIGH FLOW DIVERTOR UPPER PARTS
MRP: 2820/-



CAT NO.: A-1317
CONCEALED WALL MIXER 20MM
MRP: 6020/-



CAT NO.: A-1318
HIGH FLOW DIVERTOR
COMPLETE SET
MRP: 7050/-



Luxurious

BATHROOM

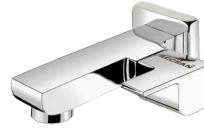

CAT NO.: A-701
BIB COCK
MRP: 1115/-



CAT NO.: A-702
PILLAR COCK
MRP: 1890/-



CAT NO.: A-703
ANGLE COCK
MRP: 1060/-



CAT NO.: A-704
BIB COCK LONG BODY
MRP: 1325/-



CAT NO.: A-705
2 WAY BIB COCK
MRP: 1930/-



CAT NO.: A-706
CONCEALED STOP COCK
15MM THREAD MRP: 1400/-
20MM THREAD MRP: 1550/-



CAT NO.: A-707
SINK COCK (W/M)
MRP: 2460/-



CAT NO.: A-708
SWAN NECK (T/M)
MRP: 2830/-



CAT NO.: A-709
WALL MIXER WITH BEND
MRP: 5690/-



CAT NO.: A-710
3 IN 1 WALL MIXER
MRP: 6165/-



CAT NO.: A-711
FLUSH COCK 25MM
MRP: 1850/-



CAT NO.: A-712
CONCEALED WALL MIXER 20MM
MRP: 6250/-



CAT NO.: A-713
HIGH FLOW SINGLE LEVER UPPER PART
MRP: 3250/-

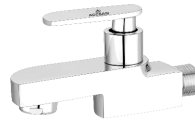

CAT NO.: A-401
BIB COCK
MRP: 1350/-



CAT NO.: A-402
PILLAR COCK
MRP: 1780/-



CAT NO.: A-403
ANGLE COCK
MRP: 815/-

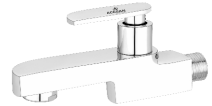

CAT NO.: A-404
BIB COCK LONG BODY
MRP: 1610/-



CAT NO.: A-405
2 WAY BIB COCK
MRP: 2010/-



CAT NO.: A-406
CONCEALED STOP COCK
15MM THREAD MRP: 1400/-
20MM THREAD MRP: 1550/-

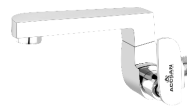

CAT NO.: A-407
SINK COCK (W/M)
MRP: 2310/-

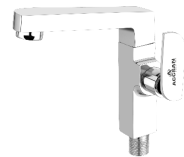

CAT NO.: A-408
SWAN NECK (T/M)
MRP: 2550/-



CAT NO.: A-409
FLUSH COCK 25MM
MRP: 1750/-



CAT NO.: A-410
WALL MIXER WITH BEND
MRP: 6650/-



CAT NO.: A-411
3 IN 1 WALL MIXER
MRP: 6980/-



CAT NO.: A-412
HIGH FLOW DIVERTOR UPPER PART
MRP: 3040/-

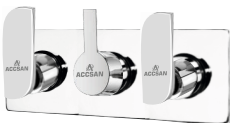

CAT NO.: A-413
CONCEALED WALL MIXER 20MM
MRP: 6230/-



CAT NO.: A-414
METROPOLE 1" (25MM)
MRP: 4790/-

CAT NO.: A-415
METROPOLE 1.25" (32MM)
MRP: 4890/-

CAT NO.: A-416
METROPOLE 1.5" (40MM)
MRP: 4995/-



CAT NO.: A-417
HIGH FLOW DIVERTOR
COMPLETE SET
MRP: 7200/-



CAT NO.: A-301
BIB COCK
MRP: 850/-



CAT NO.: A-302
PILLAR COCK
MRP: 1160/-



CAT NO.: A-303
ANGLE COCK
MRP: 700/-



CAT NO.: A-304
BIB COCK LONG BODY
MRP: 1150/-



CAT NO.: A-305
2 WAY BIB COCK
MRP: 1660/-



CAT NO.: A-306
CONCEALED STOP COCK
15MM THREAD MRP: 1220/-
20MM THREAD MRP: 1350/-



CAT NO.: A-307
SINK COCK (W/M)
MRP: 1650/-



CAT NO.: A-308
SWAN NECK (T/M)
MRP: 1810/-



CAT NO.: A-309
CENTER HOLE BASIN MIXER
MRP: 3650/-



CAT NO.: A-310
SINK MIXER
MRP: 4240/-



CAT NO.: A-311
WALL MIXER WITH BEND
MRP: 5240/-



CAT NO.: A-312
PILLAR COCK TALL BODY
MRP: 2810/-



CAT NO.: A-313
FLUSH COCK 25MM
MRP: 1590/-



CAT NO.: A-314
3 IN 1 WALL MIXER
MRP: 5550/-



CAT NO.: A-315
WALL MIXER WITH CRUTCH
MRP: 5240/-



CAT NO.: A-316
HIGH FLOW DIVERTOR UPPER PARTS
MRP: 3050/-



CAT NO.: A-317
CONCEALED WALL MIXER 20MM
MRP: 5990/-



CAT NO.: A-318
HIGH FLOW DIVERTOR
COMPLETE SET
MRP: 7050/-



CAT NO.: A-319
TWO WAY ANGLE COCK
MRP: 1550/-



CAT NO.: A-1401
BIB COCK
MRP: 830/-



CAT NO.: A-1402
PILLAR COCK
MRP: 1150/-



CAT NO.: A-1403
ANGLE COCK
MRP: 695/-



CAT NO.: A-1404
BIB COCK LONG BODY
MRP: 1140/-



CAT NO.: A-1405
2 WAY BIB COCK
MRP: 1650/-



CAT NO.: A-1406
CONCEALED STOP COCK
15MM THREAD MRP: 1200/-
20MM THREAD MRP: 1330/-



CAT NO.: A-1407
SINK COCK (W/M)
MRP: 1620/-



CAT NO.: A-1408
SWAN NECK (T/M)
MRP: 1790/-



CAT NO.: A-1409
CENTER HOLE BASIN MIXER
MRP: 3650/-



CAT NO.: A-1410
SINK MIXER
MRP: 4220/-



CAT NO.: A-1411
WALL MIXER WITH BEND
MRP: 5200/-



CAT NO.: A-1412
FLUSH COCK 25MM
MRP: 1550/-



CAT NO.: A-1413
3 IN 1 WALL MIXER
MRP: 5450/-



CAT NO.: A-1414
WALL MIXER WITH CRUTCH
MRP: 5200/-



CAT NO.: A-1501
BIB COCK
MRP: 860/-



CAT NO.: A-1502
PILLAR COCK
MRP: 1250/-



CAT NO.: A-1503
ANGLE COCK
MRP: 780/-



CAT NO.: A-1504
BIB COCK LONG BODY
MRP: 1080/-



CAT NO.: A-1505
2 WAY BIB COCK
MRP: 1730/-



CAT NO.: A-1506
CONCEALED STOP COCK
15MM THREAD MRP: 1150/-
20MM THREAD MRP: 1250/-



CAT NO.: A-1507
SINK COCK (W/M)
MRP: 1510/-



CAT NO.: A-1508
SWAN NECK (T/M)
MRP: 1760/-



CAT NO.: A-1510
SINK MIXER
MRP: 4180/-



CAT NO.: A-1511
WALL MIXER WITH BEND
MRP: 5270/-



CAT NO.: A-1512
PILLAR COCK TALL BODY
MRP: 2650/-



CAT NO.: A-1513
FLUSH COCK 25MM
MRP: 1500/-





CAT NO.: A-201
BIB COCK
MRP: 745/-



CAT NO.: A-202
PILLAR COCK
MRP: 1060/-



CAT NO.: A-203
ANGLE COCK
MRP: 670/-



CAT NO.: A-204
BIB COCK LONG BODY
MRP: 990/-



CAT NO.: A-205
2 WAY BIB COCK
MRP: 1580/-



CAT NO.: A-206
CONCEALED STOP COCK
15MM THREAD MRP: 1050/-
20MM THREAD MRP: 1150/-



CAT NO.: A-207
SINK COCK (W/M)
MRP: 1580/-



CAT NO.: A-208
SWAN NECK (T/M)
MRP: 1750/-



CAT NO.: A-209
CENTER HOLE BASIN MIXER
MRP: 3650/-

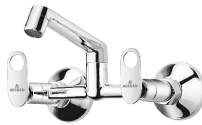

CAT NO.: A-210
SINK MIXER
MRP: 4170/-



CAT NO.: A-211
WALL MIXER WITH BEND
MRP: 5130/-



CAT NO.: A-212
PILLAR COCK TALL BODY
MRP: 2600/-



CAT NO.: A-213
FLUSH COCK 25MM
MRP: 1510/-



CAT NO.: A-214
3 IN 1 WALL MIXER
MRP: 5550/-



CAT NO.: A-215
WALL MIXER WITH CRUTCH
MRP: 5130/-



CAT NO.: A-1801
BIB COCK
MRP: 1405/-



CAT NO.: A-1802
PILLAR COCK
MRP: 1935/-



CAT NO.: A-1803
ANGLE COCK
MRP: 1135/-



CAT NO.: A-1804
BIB COCK LONG BODY
MRP: 1665/-



CAT NO.: A-1805
2 WAY BIB COCK
MRP: 2150/-



CAT NO.: A-1806
CONCEALED STOP COCK
15MM THREAD MRP: 1480/-
20MM THREAD MRP: 1580/-



CAT NO.: A-1807
SINK COCK (W/M)
MRP: 2350/-



CAT NO.: A-1808
SWAN NECK (T/M)
MRP: 2530/-



CAT NO.: A-1809
WALL MIXER WITH BEND
MRP: 6210/-



CAT NO.: A-1810
3 IN 1 WALL MIXER
MRP: 6650/-



CAT NO.: A-1811
FLUSH COCK 25MM
MRP: 1990/-



CAT NO.: A-1812
FLUSH COCK 25MM
MRP: 4250/-



CAT NO.: A-1813
HIGH FLOW SINGLE LEVER UPPER PART
MRP: 3350/-



CAT NO.: A-1814
SINGLE LEVER BASIN MIXER
MRP: 6250/-



CAT NO.: A-101
BIB COCK
MRP: 760/-



CAT NO.: A-102
PILLAR COCK
MRP: 1090/-



CAT NO.: A-103
ANGLE COCK
MRP: 715/-



CAT NO.: A-104
BIB COCK LONG BODY
MRP: 980/-



CAT NO.: A-105
2 WAY BIB COCK
MRP: 1600/-



CAT NO.: A-106
CONCEALED STOP COCK
15MM THREAD MRP: 1070/
20MM THREAD MRP: 1180/-



CAT NO.: A-107
SINK COCK (W/M)
MRP: 1530/-



CAT NO.: A-108
SWAN NECK (T/M)
MRP: 1650/-



CAT NO.: A-109
CENTER HOLE BASIN MIXER
MRP: 3600/-

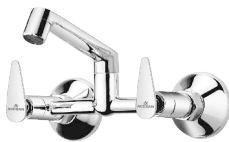

CAT NO.: A-110
SINK MIXER
MRP: 4150/-



CAT NO.: A-111
WALL MIXER WITH BEND
MRP: 5120/-



CAT NO.: A-112
PILLAR COCK TALL BODY
MRP: 2650/-



CAT NO.: A-113
FLUSH COCK 25MM
MRP: 1550/-



CAT NO.: A-114
3 IN 1 WALL MIXER
MRP: 5500/-



CAT NO.: A-115
WALL MIXER WITH CRUTCH
MRP: 5120/-



CAT NO.: A-116
SINK COCK (W/M) SIDE
MRP: 1670/-



CAT NO.: A-117
HIGH FLOW DIVERTOR UPPER PARTS
MRP: 2710/-

CAT NO.: A-120
HIGH FLOW DIVERTOR COMPLETE SET
MRP: 7050/-



CAT NO.: A-118
PROJECT CONCEALED COCK
MRP: 750/-



CAT NO.: A-119
PROJECT FLUSH COCK
MRP: 1150/-



CAT NO.: A-121
TWO WAY ANGLE COCK
MRP: 1480/-

3 YEARS
WARRANTY

3 YEARS
WARRANTY



CAT NO.: A-801
BIB COCK
MRP: 710/-



CAT NO.: A-802
PILLAR COCK
MRP: 980/-



CAT NO.: A-803
ANGLE COCK
MRP: 660/-



CAT NO.: A-804
BIB COCK LONG BODY
MRP: 94 0/-



CAT NO.: A-805
2 WAY BIB COCK
MRP: 1420/-



CAT NO.: A-806
CONCEALED STOP COCK
15MM THREAD MRP: 990/-
20MM THREAD MRP: 1090/-



CAT NO.: A-807
SINK COCK (W/M)
MRP: 1430/-



CAT NO.: A-808
SWAN NECK (T/M)
MRP: 1540/-



CAT NO.: A-810
SINK MIXER
MRP: 3415/-



CAT NO.: A-811
WALL MIXER WITH BEND
MRP: 5070/-



CAT NO.: A-812
FLUSH COCK 25MM
MRP: 1160/-



CAT NO.: A-813
2 WAY ANGLE COCK
MRP: 1360/-



3 YEARS
WARRANTY

CAT NO.: A-814
PROJECT CONCEALED COCK
MRP: 750/-



3 YEARS
WARRANTY

CAT NO.: A-815
PROJECT FLUSH COCK
MRP: 1150/-



CAT NO.: A-601
BIB COCK
MRP: 750/-



CAT NO.: A-602
PILLAR COCK
MRP: 990/-



CAT NO.: A-603
ANGLE COCK
MRP: 670/-



CAT NO.: A-604
BIB COCK LONG BODY
MRP: 950/-



CAT NO.: A-605
2 WAY BIB COCK
MRP: 1560/-



CAT NO.: A-606
CONCEALED STOP COCK
15MM THREAD MRP: 1010/-
20MM THREAD MRP: 1110/-



CAT NO.: A-607
SINK COCK (W/M)
MRP: 1530/-



CAT NO.: A-608
SWAN NECK (T/M)
MRP: 1700/-



CAT NO.: A-609
CENTER HOLE BASIN MIXER
MRP: 3640/-



CAT NO.: A-610
SINK MIXER
MRP: 3930/-



CAT NO.: A-611
WALL MIXER WITH BEND
MRP: 5100/-



CAT NO.: A-612
FLUSH COCK 25MM
MRP: 1350/-



CAT NO.: A-613
3 IN 1 WALL MIXER
MRP: 5300/-

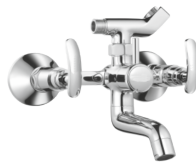

CAT NO.: A-614
WALL MIXER WITH CRUTCH
MRP: 5100/-



CAT NO.: A-615
PILLAR COCK TALL BODY
MRP: 2830/-



CAT NO.: A-616
SIDE SINK COCK
MRP: 1650/-



CAT NO.: A-617
HIGH FLOW DIVERTOR UPPER PARTS
MRP: 2760/-



CAT NO.: A-618
PROJECT CONCEALED COCK
MRP: 750/-



CAT NO.: A-619
PROJECT FLUSH COCK
MRP: 1150/-



CAT NO.: A-620
HIGH FLOW DIVERTOR COMPLETE SET
MRP: 7050/-

3 YEARS WARRANTY

3 YEARS WARRANTY



CAT NO.: A-901
BIB COCK
MRP: 850/-



CAT NO.: A-902
PILLAR COCK
MRP: 1150/-



CAT NO.: A-903
ANGLE COCK
MRP: 690/-



CAT NO.: A-904
BIB COCK LONG BODY
MRP: 1080/-



CAT NO.: A-905
2 WAY BIB COCK
MRP: 1630/-



CAT NO.: A-906
CONCEALED STOP COCK
15MM THREAD MRP: 1180/
20MM THREAD MRP: 1280/-



CAT NO.: A-907
SINK COCK (W/M)
MRP: 1590/-



CAT NO.: A-908
SWAN NECK (T/M)
MRP: 1750/-



CAT NO.: A-909
CENTER HOLE BASIN MIXER
MRP: 3470/-



CAT NO.: A-910
SINK MIXER
MRP: 3830/-



CAT NO.: A-911
WALL MIXER WITH BEND
MRP: 5130/-



CAT NO.: A-912
PILLAR COCK TALL BODY
MRP: 2700/-



CAT NO.: A-913
FLUSH COCK 25MM
MRP: 1570/-



CAT NO.: A-914
3 IN 1 WALL MIXER
MRP: 5410/-



CAT NO.: A-915
WALL MIXER WITH CRUTCH
MRP: 5130/-



CAT NO.: A-916
SINK COCK (W/M) SIDE
MRP: 1660/-



CAT NO.: A-917
HIGH FLOW DIVERTOR UPPER PARTS
MRP: 2830/-



CAT NO.: A-918
CONCEALED WALL MIXER
MRP: 6050/-



CAT NO.: A-919
2 WAY ANGLE COCK
MRP: 1410/-



CAT NO.: A-920
HIGH FLOW DIVERTOR
COMPLETE SET
MRP: 7050/-



CAT NO.: A-501
BIB COCK
MRP: 705/-



CAT NO.: A-502
PILLAR COCK
MRP: 960/-



CAT NO.: A-503
ANGLE COCK
MRP: 650/-



CAT NO.: A-504
BIB COCK LONG BODY
MRP: 940/-



CAT NO.: A-505
2 WAY BIB COCK
MRP: 1390/-



CAT NO.: A-506
CONCEALED STOP COCK
15MM THREAD MRP: 980/-
20MM THREAD MRP: 1080/-



CAT NO.: A-507
SINK COCK (W/M)
MRP: 1450/-



CAT NO.: A-508
SWAN NECK (T/M)
MRP: 1550/-



CAT NO.: A-510
SINK MIXER
MRP: 3270/-

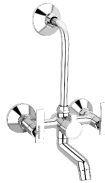

CAT NO.: A-511
WALL MIXER WITH BEND
MRP: 4850/-



CAT NO.: A-512
FLUSH COCK 25MM
MRP: 1305/-



CAT NO.: A-513
2 WAY ANGLE COCK
MRP: 1310/-



CAT NO.: A-514
SINK COCK (W/M) SIDE
MRP: 1550/-



CAT NO.: A-515
3 IN 1 WALL MIXER
MRP: 5100/-



CAT NO.: A-516
PILLAR COCK TALL BODY
MRP: 2560/-



CAT NO.: A-517
HIGH FLOW DIVERTOR UPPER PARTS
MRP: 2615/-



CAT NO.: A-518
PROJECT CONCEALED COCK
MRP: 750/-

3 YEARS
WARRANTY



CAT NO.: A-519
PROJECT FLUSH COCK
MRP: 1150/-

3 YEARS
WARRANTY



CAT NO.: A-520
HIGH FLOW DIVERTOR
COMPLETE SET
MRP: 6950/-

MOUTH FLOW

Collection



CAT NO.: A-1001
BIB COCK
MRP: 1530/-



CAT NO.: A-1002
PILLAR COCK REGULAR
MRP: 2520/-



CAT NO.: A-1003
PILLAR COCK HIGH NECK
MRP: 3050/-



CAT NO.: A-1004
PILLAR COCK LONG HIGH NECK
MRP: 3480/-

DRAIN VALVE

Collection



CAT NO.: A-031
1/2" DRAIN VALVE
MRP: 890/-



CAT NO.: A-032
3/4" DRAIN VALVE
MRP: 1310/-



CAT NO.: A-033
1" DRAIN VALVE
MRP: 1880/-



CAT NO.: A-034
1-1/4" DRAIN VALVE
MRP: 3150/-



CAT NO.: A-035
1-1/2" DRAIN VALVE
MRP: 3960/-



CAT NO.: A-036
2" DRAIN VALVE
MRP: 5560/-

SPOUT

Collection



CAT NO.: A-021
SPOUT WITH FLANGE
MRP: 1270/-



CAT NO.: A-023
SPOUT WITH FLANGE
MRP: 1410/-



CAT NO.: A-025
SPOUT WITH FLANGE
MRP: 1220/-



CAT NO.: A-022
BUTTON SPOUT WITH FLANGE
MRP: 1650/-



CAT NO.: A-024
BUTTON SPOUT WITH FLANGE
MRP: 1750/-



CAT NO.: A-026
BUTTON SPOUT WITH FLANGE
MRP: 1550/-



CAT NO.: A-027
SINGLE LEVER CONCEALED DIVERTOR
MRP: 4350/-



CAT NO.: A-028
SINGLE LEVER BASIN MIXER CONCEALED DIVERTOR
MRP: 7875/-



CAT NO.: A-01
HIGH FLOW SINGLE LEVER DIVERTOR BODY
MRP: 4880/-

METROPOLE

Collection



CAT NO.: A-014
METROPOLE FLUSH VALVE 0.5"
MRP: 5170/-

CAT NO.: A-012
METROPOLE FLUSH VALVE 1.25"
MRP: 5500/-

CAT NO.: A-011
METROPOLE FLUSH VALVE 1"
MRP: 5170/-

CAT NO.: A-013
METROPOLE FLUSH VALVE 1.5"
MRP: 5820/-

CONTROL VALVE

Collection



CAT NO.: A-037
CONTROL VALVE 15MM
MRP: 1320/-

CAT NO.: A-039
CONTROL VALVE 25MM
MRP: 1920/-

CAT NO.: A-038
CONTROL VALVE 20MM
MRP: 1550/-

CAT NO.: A-040
CONTROL VALVE 40MM
MRP: 3730/-

DOCTOR

Collection



CAT NO.: A-041
DOCTOR BIB COCK
MRP: 1490/-



CAT NO.: A-042
DOCTOR PILLAR COCK
MRP: 1850/-



CAT NO.: A-043
DOCTOR BIB COCK LONG BODY
MRP: 1790/-

1 YEARS
WARRANTY

PRESS MATIC

Collection



CAT NO.: A-044
DOCTOR BIB COCK
MRP: 2020/-



CAT NO.: A-045
DOCTOR PILLAR COCK
MRP: 2280/-



CAT NO.: A-046
DOCTOR BIB COCK LONG BODY
MRP: 1850/-

PROJECT ANGLE **3** YEARS WARRANTY

Collection



CAT NO.: A-061
PROJECT ANGLE COCK
MRP: 570/-



CAT NO.: A-062
PROJECT ANGLE COCK
MRP: 570/-



CAT NO.: A-063
PROJECT ANGLE COCK
MRP: 570/-



CAT NO.: A-064
PROJECT ANGLE COCK
MRP: 570/-



CAT NO.: A-065
PROJECT ANGLE COCK
MRP: 570/-

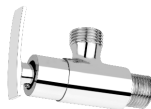

CAT NO.: A-066
PROJECT ANGLE COCK
MRP: 570/-



CAT NO.: A-067
PROJECT ANGLE COCK
MRP: 570/-

ABS HEALTH FAUCETS

Collection



CAT NO.: A-2001

HEALTH FAUCETS WITH TUBE & HOOK
MRP : 750/-



CAT NO.: A-2002

HEALTH FAUCETS WITH TUBE & HOOK
MRP : 750/-



CAT NO.: A-2003

HEALTH FAUCETS WITH TUBE & HOOK
MRP : 750/-



CAT NO.: A-2004

HEALTH FAUCETS WITH TUBE & HOOK
MRP : 680/-



CAT NO.: A-2005

HEALTH FAUCETS WITH TUBE & HOOK
MRP : 800/-



CAT NO.: A-2006

HEALTH FAUCETS WITH TUBE & HOOK
MRP : 895/-



CAT NO.: A-2007-BRASS

HEALTH FAUCETS WITH TUBE & HOOK
MRP : 1180/-



CAT NO.: A-2008-BRASS

HEALTH FAUCETS COMPLETE
MRP : 1260/-

304 S.S.SHOWER

Collection

Ultra Slim

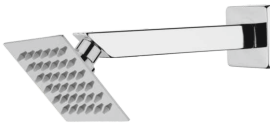

CAT NO.: A-2201
SS SHOWER 4X4"
MRP: 685/-

CAT NO.: A-2202
SS SHOWER 6X6"
MRP: 900/-

CAT NO.: A-2203
SS SHOWER 8X8"
MRP : 1250/-

Elegance



CAT NO.: A-2204
SS SHOWER 4X4"
MRP: 1010/-

CAT NO.: A-2205
SS SHOWER 6X6"
MRP: 1150/-

CAT NO.: A-2206
SS SHOWER 8X8"
MRP: 1950/-

CAT NO.: A-2207
SS SHOWER 10X10"
MRP: 2940/-

Sandwich



CAT NO.: A-2208
SS SHOWER 4X4"
MRP: 815/-

CAT NO.: A-2209
SS SHOWER 6X6"
MRP: 1170/-

CAT NO.: A-2210
SS SHOWER 8X8"
MRP: 1810/-

OVER HEAD ABS SHOWER

Collection



CAT NO.: A-2301
ABS SHOWER ROUND
MRP: 790/-



CAT NO.: A-2302
ABS SHOWER ROUND
MRP: 730/-



CAT NO.: A-2303
ABS SHOWER ROUND
MRP: 720/-



CAT NO.: A-2304
ABS SHOWER ROUND
MRP: 710/-

HAND SHOWER ABS

Collection



CAT NO.: A-2401
HAND SHOWER ABS
MRP: 1380/-



CAT NO.: A-2402
HAND SHOWER ABS
MRP: 1330/-



CAT NO.: A-2403
HAND SHOWER ABS
MRP: 1460/-



CAT NO.: A-2404
HAND SHOWER ABS
MRP: 1670/-



CAT NO.: A-2405
HAND SHOWER ABS
MRP: 1530/-

ALLIED

Collection



CAT NO.: A-051
PRINCE COCK
MRP: 550/-



CAT NO.: A-052
NOZZLE COCK
MRP: 700/-



CAT NO.: A-053
PUSH COCK
MRP: 570/-



CAT NO.: A-054
PUSH ANGLE COCK
MRP: 560/-



CAT NO.: A-047
WASTE COUPLING 3" BRASS
MRP: 385/-



CAT NO.: A-048
WASTE COUPLING 3" SS
MRP: 170/-



CAT NO.: A-049
SS RACK BOLT
MRP: 148/-



CAT NO.: A-050
MS RACK BOLT
MRP: 95/-

MEDIUM



CAT NO.: A-1501
EX. NIPPLE 1"
MRP: 60/-

CAT NO.: A-1504
EX. NIPPLE 2.5"
MRP: 148/-

CAT NO.: A-1502
EX. NIPPLE 1.5"
MRP: 90/-

CAT NO.: A-1505
EX. NIPPLE 3"
MRP: 177/-

CAT NO.: A-1503
EX. NIPPLE 2"
MRP: 118/-

CAT NO.: A-1506
EX. NIPPLE 4"
MRP: 242/-

BRASS



CAT NO.: A-1601
CONNECTION PIPE 1FT
MRP: 105/-

CAT NO.: A-1602
CONNECTION PIPE 1.5FT
MRP: 130/-

CAT NO.: A-1603
CONNECTION PIPE 2FT
MRP: 147/-

CAT NO.: A-1604
CONNECTION PIPE 2.5FT
MRP: 157/-

CAT NO.: A-1605
CONNECTION PIPE 3FT
MRP: 174/-

PTMT



CAT NO.: A-1701
CONNECTION PIPE 1FT
MRP: 80/-

CAT NO.: A-1702
CONNECTION PIPE 1.5FT
MRP: 93/-

CAT NO.: A-1703
CONNECTION PIPE 2FT
MRP: 104/-

CAT NO.: A-1704
CONNECTION PIPE 2.5FT
MRP: 129/-

CAT NO.: A-1705
CONNECTION PIPE 3FT
MRP: 140/-



CAT NO.: A-049
BOTTLE TRAP SS
MRP: 1550/-



CAT NO.: A-050
BRASS NOZZLE
MRP: 95/-



CAT NO.: A-029
TWIN ANGLE COCK
MRP: 960/-

FAUCETS PARTS DETAILS



MANUFACTURING PROCESSES



SOURCING

Brass is source from the most reputed vendors and is inspected by QC staff before it is sending for casting.



POLISHING

The grinded pieces are polished on high speed polishing machines by experienced workers to achieve perfect surface with high glass & shine.



CASTING

Virgin brass and scrap is casted in various molds as per the pattern using the Die Casting Process.



PLATING

The polished and okayed pieces then undergo the process of plating finishing.



MACHINING

Casted products are machined as per the design requirements to create threads.



TESTING

The pieces are then checked for surface defects. The water carrying components are pressure tested using Hydraulic Testing machine to detect any leakage in the product.



GRINDING

The machined product is then grinded using belt grinders to achieve smooth finishes without sharp edges.



ASSEMBLY

Then pieces are assembled and once again checked and tested with Hydraulic Pressure. The tested pieces are then packed in corrugated boxes and ready for dispatch.



ACCSANTM
BATH FITTINGS

ACCSAN INDUSTRIES

Santidham, SIDC Main Road,
Shapar-Veraval-360024 Dist. Rajkot, Gujarat
Web: www.accsanbathfittings.com
Email : accsanbathfittings@gmail.com
Contact : +91 89806 45000, 89406 46000
Landline No. 02827 299664

Download Brochure



Scan Code :